

REV.	DESCRIPTION	DATE	DRAFTER	APPROVER
A1	DWG.REL	2020.05.19	LiuZH	JIN

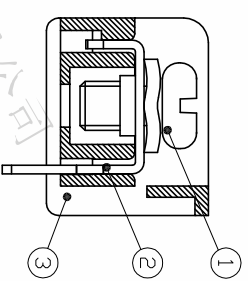
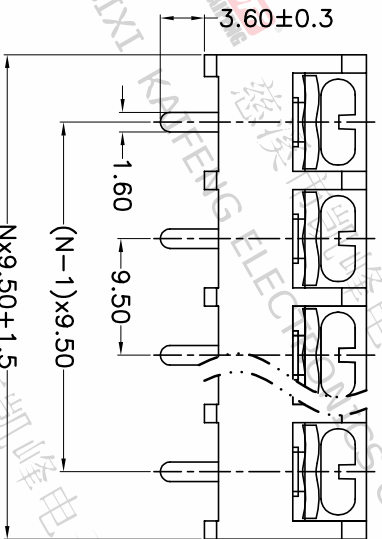
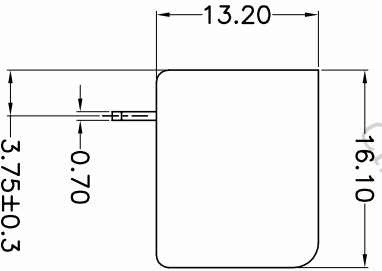
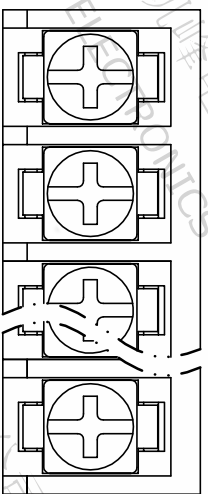

- Material
- Screws : M4.0 steel, Ni plated
- Terminal : Brass, Tin plated
- Housing : PA66, UL94V-0

- Electrical
 - UL IEC
 - Rated voltage : 300V 750V
 - Rated current : 25A 32A
 - Contact resistance : 20mΩ(Max)
 - Insulation resistance : 500MΩ/DC500V
 - Withstanding Voltage : AC2000V/1min
 - Wire range : 22-12AWG 4.0mm²

- Mechanical
 - Operating temperature: -40°C ~ +105°C
 - Soldering temperature: 250°C ±5/5sec
 - Torque: 1.2N.m (10.53lb.in)

• RoHS compliance

HOW TO ORDER

HB-950-9.5-XXP-1 X-XXXXX

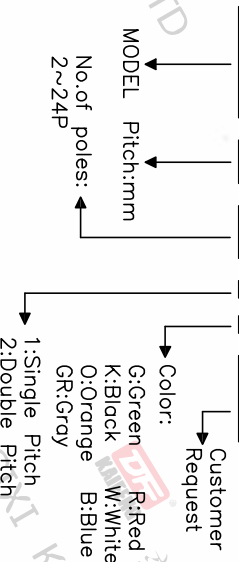

P.C.B.LAYOUT

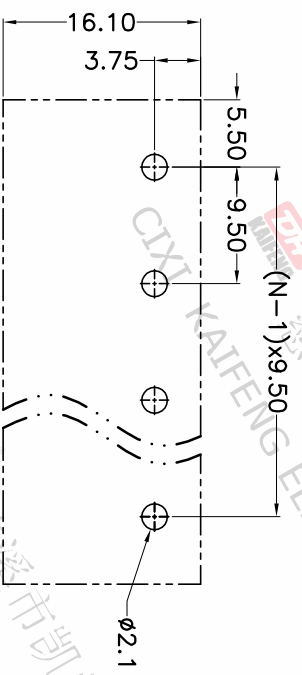

Pitch range	Nominal dimension range	Projection
>0	>30	0.1/1.0
>6	>60	0.1/1.0
~	~	~
6	100	~
10	150	~
24	>150	~
30	>150	~
±0.15, ±0.20, ±0.30, ±0.50	±0.50, ±0.70, ±1.00, ±1.30	±2'

DRAWING TYPE	CUSTOMER DRAWING
SCALE	1:1
SHEET	1 OF 1
DRAWING NO.	W12000342

PROJECTION	TITLE
UNIT	HB-950-9.5-XXP-1X
SHEET SIZE	A4
SERIES	HB-950

DFE 慈溪市凯峰电子有限公司
CIXI KAIFENG ELECTRONICS CO.,LTD